

# HOW TO WASH YOUR CAR THE GTECHNIQ WAY



**TOP TIP:**  
Try to wash your car in the shade, this will prevent soap suds from drying prematurely before you have a chance to rinse them off. When this is not possible, soap suds should be rinsed panel by panel. Rinse with an open-ended hose, this allows the water to sheet, making drying an easier task



If your rims and wheel arches are very dirty and, or caked with brake dust, spray Iron And Fallout Remover onto your car's wheels and a neat solution of Citrus All Purpose Cleaner into your wheel arches.



Leave the Iron and Fallout Remover and Citrus All Purpose Cleaner to dwell for three to five minutes. During this time any ferrous particles will dissolve into the Iron And Fallout Remover solution turning it bright purple.



Hose or jet wash your wheels and wheel arch liners to remove as much loose dirt as possible. If your rims and arches are still coated with dirt and, or brake dust, reapply the Iron and Fallout Remover and Citrus All Purpose Cleaner and agitate the dirty areas with the appropriate brushes. Namely a soft detail brush for wheel nuts, a soft wheel brush for rims and a long handled wheel arch brush for your wheel arches. And then rinse with a hose or jet wash.



**NOTE**  
Throughout the wash process, make sure you use plenty of soap suds on your mitt and rinse it thoroughly. Keep an eye on the water becoming too dirty, and replace both buckets as and when necessary

Fill one bucket of water with Gwash solution, and another with fresh water - use grit guards in the bottom, if you have them, to prevent larger dirt particles mixing in the water. Dunk the WM2 Microfibre Wash Mitt into the suds, wash a wheel and arch at a time. Rinse the wash mitt in the clean water bucket to release the dirt, before dipping it into the soapy bucket again and starting the next wheel and arch.



Apply a thick layer of Citrus Foam all over your cool, dry car using a foam lance. If you do not have a foam lance then dilute Citrus All Purpose Cleaner as much as 1:5, depending on how dirty your car is.



Once applied leave the Citrus Foam or Citrus All Purpose Cleaner to dwell on the car for up to five minutes and rinse the foam from the car at a relatively high pressure.



If the lower sides are still dirty after they have been snow foamed, spray the area with Citrus All Purpose Cleaner to dwell for three to five minutes, and rinse with clean water.



If the leading edges of your vehicle are peppered with bugs, spray Bug Remover onto the contaminated areas, leave to dwell for three to five minutes and rinse away with water.

**NOTE**  
Citrus Foam, Citrus All Purpose Cleaner and Bug Remover can be used as many times as required prior to washing. In extreme cases you may want to use a MF1 ZeroR Microfibre Buff Cloth to agitate the surface



**NOTE**  
Always begin washing the paintwork on the upper surfaces - roof, bonnet and boot, and work your way down. Wash following the lines of the car, using a back and forth, or side to side motion. Circular motions when washing will pronounce any swirl marks

If you have not done STEPS 5 through to 8, hose or jet wash your car to remove any loose dirt. Next, fill one bucket of water with a fresh Gwash solution, and another with fresh water - use grit guards in the bottom, if you have them, to prevent large dirt particles mixing in the water. Dunk a fresh WM2 Microfibre Wash Mitt into the shampoo, gently wash a panel and then rinse it in the clean water. Repeat as you go around the car.



After washing, if there are any black spots, this is tar. Spray Tar and Glue Remover directly onto an MF1 and apply to the affected area, avoid getting it on any of your vehicle's trim, vinyl, number plates or rubber and plastic parts. Allow Tar and Glue Remover to dwell for one to two minutes before gently wiping with a microfibre cloth, and then rinse.



Rinse your car well all over with fresh water from an open ended hose or jet wash to remove all soap residues.

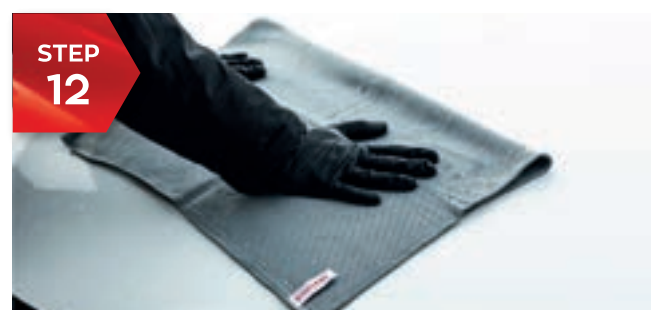

Dry all of the exterior surfaces of your car with an MF2 Zero Scratch Microfibre Drying Towel, or a MF4 Diamond Sandwich Drying Towel. Simply lay the drying towel across the surface and pull it towards you. Do not leave your car to dry naturally as this will leave water spots.

**NOTE**  
Never use a real leather chamois for drying as they are too harsh for modern paints and can scratch the surface







**STEP 13**  
Clean all of the exterior glass with Perfect Glass for a streak-free finish.



**STEP 14**  
Use Gtechniq Quick Detailer on your paintwork with a MF1 ZeroR Microfibre Buff Cloth for a streak and spot-free finish.



**STEP 15**  
Once you have dried the wheels and tyres, apply Durable Tyre Gel, or Tyre Dressing, to the tyres with an AP3 Foam Filled Applicator for a slick finish.

**AND YOU'RE DONE!**

## QUICK WASH FOR THE LESS DIRTY CAR



**STEP 1**  
Hose or jet wash your wheels and wheel arch liners to remove as much loose dirt as possible.



**STEP 2**  
Fill one bucket of water with Gwash solution, and another with fresh water - use grit guards in the bottom, if you have them, to prevent larger dirt particles mixing in the water. Dunk the WM2 Microfibre Wash Mitt into the suds, wash a wheel and arch at a time. Rinse the wash mitt in the clean water bucket to release the dirt before dipping it into the soapy bucket again, and starting the next wheel and arch.



**STEP 3**  
Apply a thick layer of Citrus Foam all over your cool, dry car using a foam lance. If you do not have a foam lance then dilute Citrus All Purpose Cleaner as much as 1:5, depending on how dirty your car is.



**STEP 4**  
Once applied leave the Citrus Foam or Citrus All Purpose Cleaner to dwell on the car for up to five minutes and rinse the foam from the car at a relatively high pressure.



**STEP 5**  
Next, fill one bucket of water with a fresh Gwash solution, and another with fresh water - use grit guards in the bottom, if you have them, to prevent large dirt particles mixing in the water. Dunk a fresh WM2 Microfibre Wash Mitt into the shampoo, gently wash a panel, and then rinse it in the clean water. Repeat as you go around the car.

**STEP 5** **NOTE**  
Always begin washing the paintwork on the upper surfaces - roof, bonnet and boot, and work your way down. Wash following the lines of the car, using a back and forth, or side to side motion. Circular motions when washing will pronounce any swirl marks

**STEP 6** **NOTE**  
Never use a real leather chamois for drying as they are too harsh for modern paints and can scratch the surface



**STEP 6**  
Dry all of the exterior surfaces of your car with an MF2 Zero Scratch Microfibre Drying Towel, or a MF4 Diamond Sandwich Drying Towel. Simply lay the drying towel across the surface and pull it towards you. Do not leave your car to dry naturally as this will leave water spots.



**STEP 7 (OPTIONAL)**  
In our opinion, nothing sets a car off better than dressed tyres, sparkling clear glass and every last trace of water removed from its finish. To achieve this go over your paintwork with Quick Detailer and an MF1 ZeroR Microfibre Buff Cloth, clean the glass with Perfect Glass and a MF5 Power Glass Cloth, and dress the tyres with Durable Tyre Gel using an AP3 Dual Layered Soft Foam Applicator.



**STEP 8 (OBLIGATORY)**  
Give yourself a pat on the back for a job well done and smile through gritted teeth when your annoying neighbour says "you can wash mine now".